

**Partner for  
food conveying solutions**

## Homogeneous and Drive belts

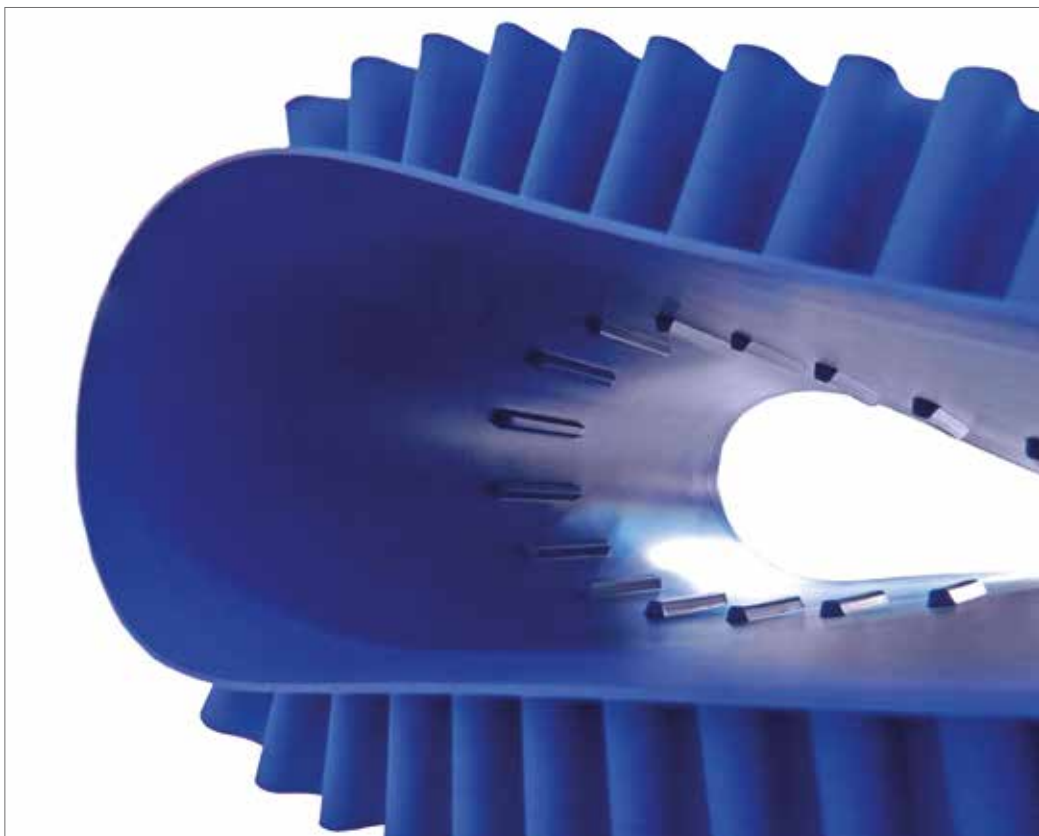



## The ultimate solution for total hygiene

HP COMPACT® is a homogeneous conveyor and process belts - smooth or positive drive - assuring **total hygiene** and designed to resist the **most severe cleaning** procedures.

It goes beyond the application limits of both modular and monolithic belts, reinforced or not, commonly found in the market.

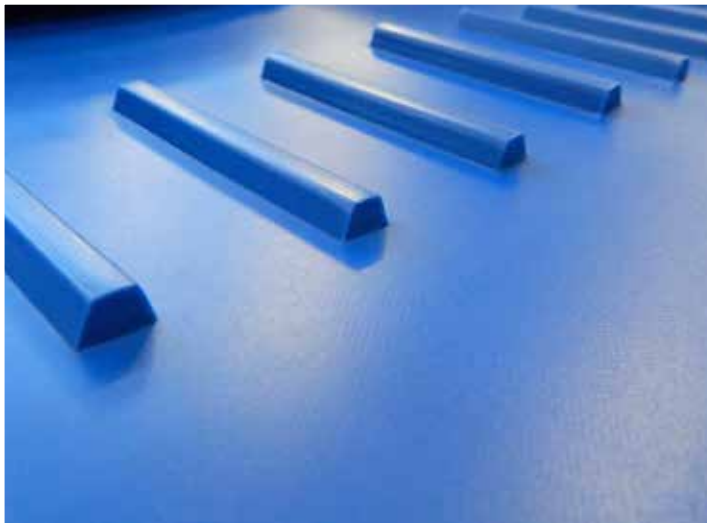

## HP COMPACT® conveying systems



**Compact belt design, reinforced traction core.**  
The HP COMPACT® belts assure the total compliance with the requisites imposed by the HACCP practice in the whole production process.

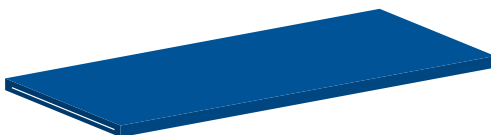

**Compact belt having a reinforced traction core and toothed profile on the running side.**  
The HP COMPACT DRIVE® belts for positive drive can be supplied with any kind of teeth and pitch, both standard and customized.

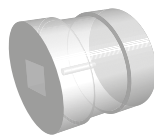
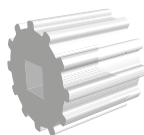
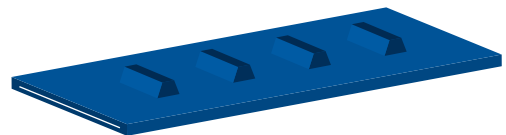

Chiorino supplies standard or customized pulleys according to Customer's needs.



## Certified Food Compliance

**REGULATION EC 1935/2004** and amendments

**REGULATION EC 2023/2006** and amendments

**REGULATION EU 10/2011** and amendments

**FDA (Food and Drug Administration)**

**REGULATION NSF/ANSI 3-A 14159-3-2014** and amendments

**USDA (United States Department of Agriculture)**



# Food belts and hygienic requirements

HP COMPACT DRIVE® is the answer to the most demanding requirements of Food industry in terms of **food safety** and **mechanical performances**.

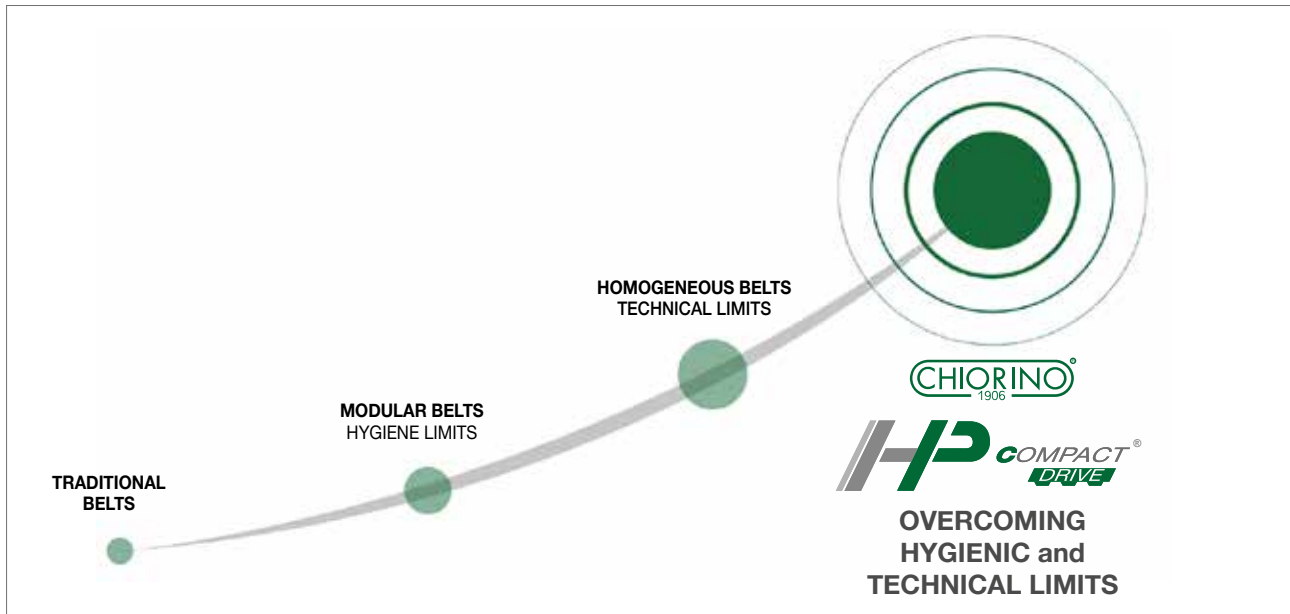

## HP COMPACT DRIVE® main benefits

- 100% Food safety
- Superior resistance to washing and sanitizing
- Excellent resistance to fats and oils
- No deformations
- Self-tracking
- Ideal for Z-Conveyors
- Up to 2000 mm width

### Optimized cost of ownership

HP COMPACT DRIVE® belts guarantee a considerable **Time, Water, Energy** and **Maintenance saving** compared to modular and traditional homogeneous or monolithic belts.



-60%



-60%



-50%



-60%

# The benchmark in food processing

The Chiorino HP® conveyor and process belts are today the leading products for the food industry as far as **hygiene**, **performance** and **working life** are concerned.

The HP® belts fully support all the **HACCP practices** through the whole food manufacturing process.



## HP® SYSTEM main benefits

- **Extraordinary resistance to continuous washing and sanitization processes. Ideal for Clean-in-Place systems**
- **Superior resistance to fats and oils**
- **Excellent resistance to low temperatures**
- **Optimized cost of ownership**



## HP® PRODUCT SYSTEM

### Resistance to oils and chemical agents

The HP® belts ensure an excellent resistance to the chemical agents, fats and aggressive oils, including palm and coconut oil.

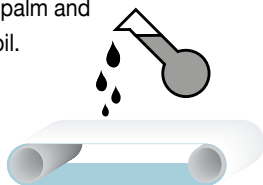

### Resistance to hydrolysis

The HP® belts guarantee an excellent resistance to hydrolysis as well as the chemical and mechanical action of washing with hot water and steam, including in continuous systems.

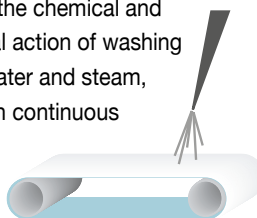

### Resistance to high/low temperatures

The HP® belts offer increased resistance to high temperatures when compared to the traditional polyurethane belts and maintain their characteristics even at lowest temperatures.

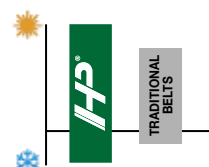

# Total food safety and water saving

## Modular belts

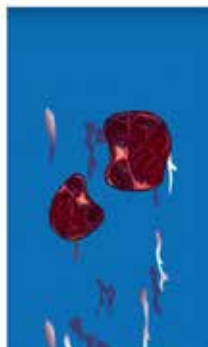
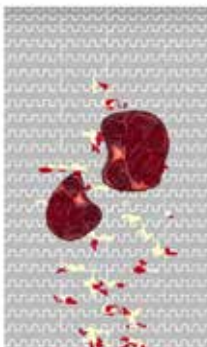

Modular belts require a high initial investment and show critical issues related to cleanability and food safety.

Chiorino HP COMPACT DRIVE® **washing is quick and easy**, assuring total hygiene and reducing downtime to a minimum.

Modular belts require an excessive water and energy consumption, still resulting in an effectively impossible sanitization.

Up to **60% water saving** compared to modular belts is one of the main competitive advantages of HP COMPACT DRIVE® belts.

Even after long cleaning operations, foodstuff residuals remain on modular belts surface, resulting in poor hygiene.

HP COMPACT DRIVE® belts' surface is perfectly clean and safe, ready for starting further operations assuring **total food safety**.

# Excellent resistance to bacterial proliferation

## Monolithics and traditional homogeneous belts

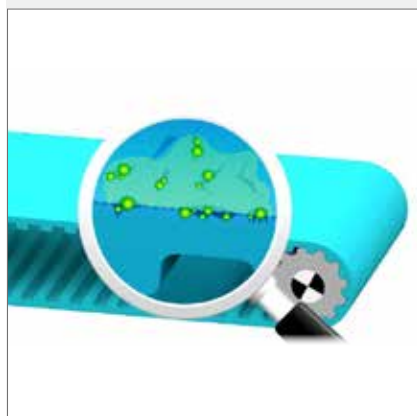

Frequent washings affect the conveyor belts' surface that undergoes the hydrolisis attack, with heavy consequences in terms of hygiene and belts' life.

The porous surface of monolithics and traditional homogeneous belts particularly suffers the hydrolisis effect.

The surface of traditional monolithic belts cracks and becomes a natural shelter for bacterial growth.

The **highly compact polyurethane** resulting from the exclusive Chiorino **HP® product system** resists to hydrolisis more than any other belt with no crackings on the surface.

If bacteria are not completely removed there is a considerable risk of bacterial layer formation on the belts' surface.

Thanks to the HP® closed and compact surface, bacteria are completely removed.

This makes HP COMPACT DRIVE® the **best solution for total food safety**.





# Excellent mechanical stability

Monolithics  
and traditional  
homogeneous belts

















One of the biggest issues of traditional homogeneous and monolithic belts is the poor resistance to hydrolisis.

After frequent washing processes, their polymeric material quickly ages causing wavings, deformation and finally tracking problems.

HP COMPACT DRIVE® guarantees a superior resistance to hydrolisis overcoming the technical and mechanical limits of monolithic and traditional homogeneous belts.

Monolithics and traditional homogeneous belts suffer waving and deformations and require frequent and expensive maintenance.

HP COMPACT DRIVE® is **mechanically stable, constant running and trouble free.**

# Ideal for all conveyor designs

The special **Chiorino compact reinforced traction core** assures unlimited flexible and innovative configurations, making HP COMPACT DRIVE® ideal for the use on all demanding applications such as swan neck conveyors.

KEY FEATURES		MAIN BENEFITS
Compact reinforced traction core	▶	No deformations Cross rigidity Self tracking No elongations Low fitting tension
Exclusive design	▶	No vibrations Ideal for Z-conveyors Up to 2000 mm width



***Beyond the limits of custom solutions!***

HP COMPACT DRIVE® is produced in **2000 mm width** and no length limits for endless belts.

It can be supplied with a **double row of teeth** up to 2000 mm belts' width.

HP COMPACT DRIVE® is the **unique homogeneous reinforced belt** available in **2000 mm** width.

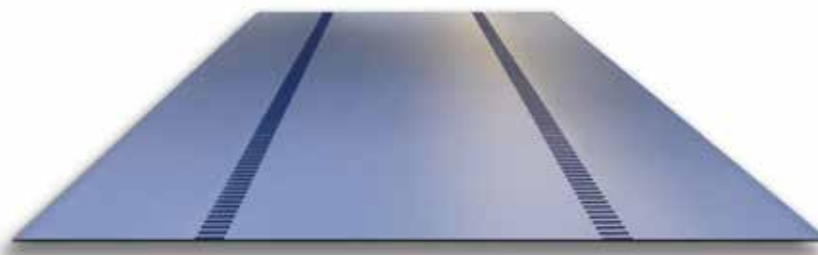



# Pitches and pulleys

The traditional positive drive conveyor construction consists of:

- **Drive pulley**
- **Slidebed**
- **Idle pulley with tensioning device**
- **Support pulleys**

Chiorino supplies both **standard** and **customized pulleys** according to Customer's needs.

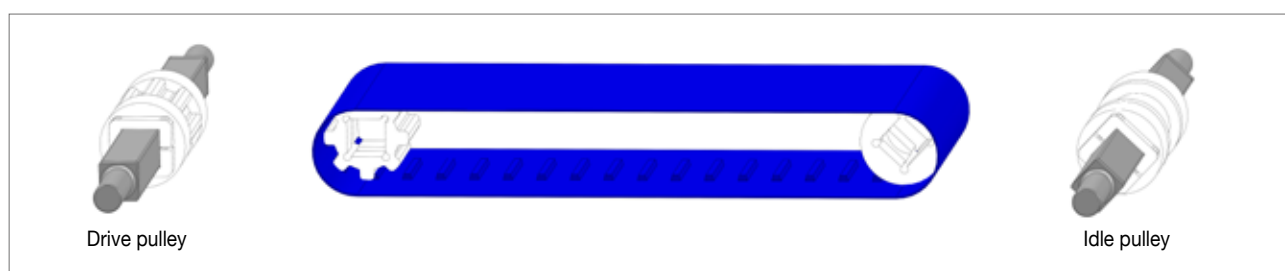

## Chiorino standard sprockets / pulleys

Drive pulley

Idle pulley

Support pulley

Number  
of  
teeth

Pitch  
mm

External  
Ø  
A  
mm

Inner square  
□  
B  
mm

Width  
C  
mm

External  
Ø  
D  
mm

Inner square  
□  
E  
mm

Width  
F  
mm

External  
Ø  
G  
mm

Inner square  
□  
H  
mm

Width  
I  
mm

**HP** COMPACT  
mini DRIVE

9	20	55	20 x 20	80
10	20	62	25 x 25	80
11	20	68	25 x 25	80
12	20	74	25 x 25	80

55	20 x 20	105
62	25 x 25	105
68	25 x 25	105
74	25 x 25	105

55	20 x 20	20
62	25 x 25	20
68	25 x 25	20
74	25 x 25	20

**HP** COMPACT<sup>1</sup>  
DRIVE

8	40	99	40 x 40	80
10	40	125	40 x 40	80
12	40	150	40 x 40	80
14	40	176	40 x 40	80
16	40	201	40 x 40	80

99	40 x 40	105
125	40 x 40	105
150	40 x 40	105
176	40 x 40	105
201	40 x 40	105



99	40 x 40	20
125	40 x 40	20
150	40 x 40	20
176	40 x 40	20
201	40 x 40	20

<sup>1</sup> On demand HP COMPACT DRIVE® belts can be supplied with customized pitches.

# Profiles and Sidewalls

Code	Type	Dimensions b x h mm	Material	Hardness Sh A / Sh D	Min. transversal pitch mm	Min. transversal diameter <sup>1</sup> mm
------	------	---------------------------	----------	-------------------------	---------------------------------	---

## Transversal profiles

	ES-543	L20 U HP blue	10 x 20	TPU HP®	70 Sh A	40	40
	ES-546	L30 U HP blue	10 x 30	TPU HP®	70 Sh A	40	40
	ES-549	L40 U HP blue	10 x 40	TPU HP®	70 Sh A	40	40
	ES-535	L50 U HP blue	10 x 50	TPU HP®	70 Sh A	40	40
	ES-538	L80 U HP blue	10 x 80	TPU HP®	70 Sh A	40	40
	ES-731	L80 U HP blue 55D	10 x 80	TPU HP®	55 Sh D	40	40
	ES-563	T20 U HP blue	10 x 20	TPU HP®	70 Sh A	40	40
	ES-560	T30 U HP blue	10 x 30	TPU HP®	70 Sh A	40	40
	ES-557	T40 U HP blue	10 x 40	TPU HP®	70 Sh A	40	40
	ES-554	T50 U HP blue	10 x 50	TPU HP®	70 Sh A	40	40
	ES-534	T60 U HP blue	10 x 60	TPU HP®	70 Sh A	40	40
	ES-713	T50 U HP blue 55D	10 x 50	TPU HP®	55 Sh D	40	40
	ES-793	T100 U HP blue 55MD <sup>2</sup>	10 x 100	TPU HP®	55 Sh D	40	50
	ES-785	T120 U HP blue 55MD <sup>2</sup>	10 x 120	TPU HP®	55 Sh D	40	50

## Sidewalls

	Code	Type	Dimensions			Material	Hardness Sh A	Thickness mm	Minimum diameter <sup>1</sup> mm
			Pitch mm	Width mm	Height mm				
	ES-707	C-U 10/20 HP blue	24	22	20	TPU HP®	85	1.6	50
	ES-708	C-U 10/30 HP blue	24	22	30	TPU HP®	85	1.6	70
	ES-709	C-U 10/40 HP blue	24	22	40	TPU HP®	85	1.6	100
	ES-710	C-U 10/50 HP blue	24	22	50	TPU HP®	85	1.6	120
	ES-711	C-U 20/60 HP blue	50	42	60	TPU HP®	85	1.6	150
	ES-712	C-U 20/80 HP blue	50	42	80	TPU HP®	85	1.6	190
	ES-763	C-U 20/40 HP Compact blue	40	42	40	TPU HP®	85	2.7	100
	ES-762	C-U 20/50 HP Compact blue	40	42	50	TPU HP®	85	2.7	120
	ES-764	C-U 20/60 HP Compact blue	40	42	60	TPU HP®	85	2.7	145
	ES-765	C-U 20/80 HP Compact blue	40	42	80	TPU HP®	85	2.7	200
	ES-794	C-U 20/100 HP Compact blue	40	42	100	TPU HP®	85	2.7	240
	ES-795	C-U 20/120 HP Compact blue	40	42	120	TPU HP®	85	2.7	290

<sup>1</sup> Minimum pulley diameters referred to environment conditions of 20°C.

<sup>2</sup> Available in 800 mm lenght bars.

## 

HY-FAST™ is a **unique hygienic fastener** designed by Chiorino for the **installation on site** of HP COMPACT DRIVE® food conveyor belts. Made of thermoplastic food compliant material, it does not contain any metal component.

### QUICK & EASY

Thanks to HY-FAST™ the belt can be easily replaced for the *daily cleaning procedures* then *instantly and easily* fitted on the machine.





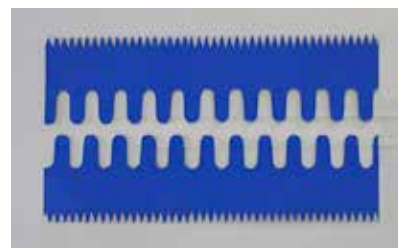

### KEY BENEFITS

- Food safety
- High mechanical resistance
- Excellent resistance to frequent washings
- Suitable for Clean-in-Place systems
- Downtime reduction

HY-FAST™ is available only for the HP COMPACT 25 series and for belts up to a max. width of 1000 mm.







# Technical data

Code	Type	Total thickness	Material	Driving toothed side surface texture	Conveying side surface texture	Pitch	Tooth section	Tooth length	Pull for 1% elong.	Min. diameter <sup>1</sup>	Temperature resistance	Max. width	Knife roller	Inclined	Swan neck	Trough
		mm				mm	b x h mm	mm	N/mm	mm	min. max. °C °C	mm				

## Positive drive homogeneous belts

NA-1366F_D6	HP Compact Minidrive 15/20 blue	1.5	TPU HP®	smooth	smooth	20	6 x 3	72	5	25	-30 +90	800	•			
NA-1359C_D13	HP Compact Drive 20/40 blue	2.0	TPU HP®	smooth	smooth	40	13 x 8	72	8	80	-30 +90	2000				•
NA-1207C_D13	HP Compact Drive 25/40 blue	2.5	TPU HP®	smooth	smooth	40	13 x 8	72	8	80	-30 +90	2000			•	
NA-1294C_D13	HP Compact Drive 25/40 PN blue	2.5	TPU HP®	smooth	PN	40	13 x 8	72	8	80	-30 +90	2000		•	•	
NA-1328C_D13	HP Compact Drive 25/40 RG blue	2.5	TPU HP®	smooth	RG	40	13 x 8	72	8	80	-30 +90	2000		•	•	
NA-1257C_D13	HP Compact Drive 25/40 VL blue	2.5	TPU HP®	smooth	VL	40	13 x 8	72	8	80	-30 +90	2000			•	
NA-1307C_D13	HP Compact Drive 40/40 blue	4.0	TPU HP®	smooth	smooth	40	13 x 8	72	15	80	-30 +90	2000			•	

## Homogeneous belts

Code	Type	Total thickness	Material	Driving toothed side surface texture	Conveying side surface texture	Pitch	Tooth section	Tooth length	Pull for 1% elong.	Min. diameter <sup>1</sup>	Temperature resistance	Max. width	Knife roller	Inclined	Swan neck	Trough
		mm				mm	b x h mm	mm	N/mm	mm	min. max. °C °C	mm				
NA-1366A	HP Compact 15 blue	1.5	TPU HP®	smooth	smooth	-	-	-	5	25	-30 +110	2000	•			
NA-1359A	HP Compact 20 blue	2.0	TPU HP®	smooth	smooth	-	-	-	8	50	-30 +110	2000				•
NA-1207A	HP Compact 25 blue	2.5	TPU HP®	smooth	smooth	-	-	-	8	50	-30 +110	2000			•	
NA-1294A	HP Compact 25 PN blue	2.5	TPU HP®	smooth	PN	-	-	-	8	50	-30 +110	2000		•	•	
NA-1328A	HP Compact 25 RG blue	2.5	TPU HP®	smooth	RG	-	-	-	8	50	-30 +110	2000		•	•	
NA-1328A RG	HP Compact RG 25 blue	2.5	TPU HP®	RG	smooth	-	-	-	8	50	-30 +110	2000			•	
NA-1257A	HP Compact 25 VL blue	2.5	TPU HP®	smooth	VL	-	-	-	8	50	-30 +110	2000			•	
NA-1307A	HP Compact 40 blue	4.0	TPU HP®	smooth	smooth	-	-	-	15	80	-30 +110	2000			•	

<sup>1</sup> Minimum roller diameter is dependent on the joint recommended by Chiorino.

The technical data are valid under normal environmental conditions and are subject to change without notice.

## EXPLANATION OF TYPE DESIGNATION

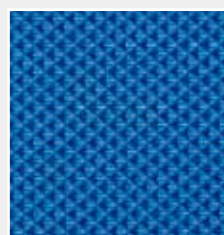
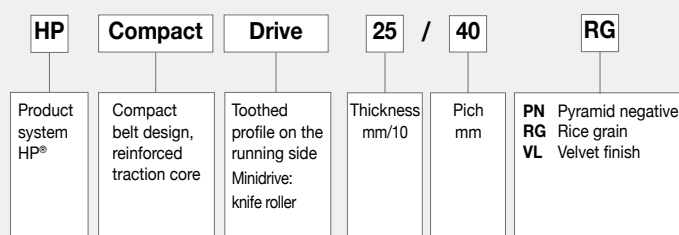

PN

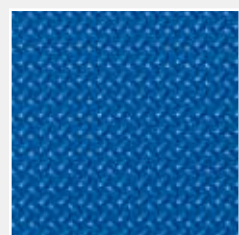

RG

## CHIORINO AFFILIATED COMPANIES

### Australia

CHIORINO AUSTRALIA PTY. LTD.  
Brisbane  
Tel. +61-7-3274 1900  
sales@chiorino.com.au  
www.chiorino.com.au

### Benelux

CHIORINO BENELUX B.V. - Utrecht,  
The Netherlands  
Tel. +31-30-2413060  
chiorino@chiorino.nl  
www.chiorino.nl

### Byelorussia

CHIORINO-K - Minsk  
Tel. +375-17-2804578  
general@chiorino.ru  
www.chiorino.ru

### China

CHIORINO ASIA Ltd.  
Hong Kong  
Tel. +852-397-10818  
info@chiorino.asia  
www.chiorino.asia

CHIORINO LIAISON OFFICE, Shanghai

Tel. +86-21-37831019  
info@chiorino.cn  
www.chiorino.cn

### France

CHIORINO SAS - Lagny, Paris  
Tel. +33-1-64304075  
chiorino.paris@chiorino.fr  
www.chiorino.fr

### Germany

CHIORINO GmbH - Mainz  
Tel. +49-(0)6131-55449-0  
info@chiorino.de  
www.chiorino.de

### Hungary

CHIORINO Kft. - Szigetszentmiklós,  
Budapest  
Tel. +36-24-525930  
mail@chiorino.hu  
www.chiorino.hu

### India

CHIORINO INDIA - Salcete Goa  
Tel. +918-322-782454  
info@chiorino.in  
www.chiorino.in

### Italy

CHIORINO PARMA s.r.l. - Parma  
Tel. +39-0521-292236  
chiorinoparma@chiorino.com

CHIORINO VENETO s.r.l. - Colle Umberto

Tel. +39-0438-430460  
chiorinoveneto@chiorino.com

### Poland

CHIORINO Sp. z o.o. - Bydgoszcz  
Tel. +48-(0)52-3487708  
chiorino@chiorino.com.pl  
www.chiorino.com.pl

### Portugal

CHIORINO PORTUGAL, LDA  
Alfena Valongo, Porto  
Tel. +35-122-9684442  
geral@chiorino.pt  
www.chiorino.pt

### Romania

CHIORINO srl - Cluj Napoca  
Tel. +40-264-432977  
chiorino@chiorino.ro  
www.chiorino.ro

### South Africa

CHIORINO SOUTH AFRICA (PTY) LTD.  
Johannesburg  
Tel. +27-11-3971268  
sales@chiorino.co.za  
www.chiorino.com

### Spain

CHIORINO IBERICA S.A. - Rubí, Barcelona  
Tel. +34-93-5860480  
chiorino@chiorino.es  
www.chiorino.es

### Switzerland

CHIORINO SCHWEIZ GmbH - Wetzikon  
Tel. +41-(0)43-3116001  
info@chiorino.ch  
www.chiorino.ch

### United Kingdom

CHIORINO U.K. Ltd. - Featherstone  
Tel. +44-1977-691880  
sales@chiorino.co.uk  
www.chiorino.co.uk

### U.S.A.

CHIORINO INC. - Newark, DE  
Tel. +1-302-292-1906  
info@chiorino.us  
www.chiorino.us

## CHIORINO DISTRIBUTORS

Albania  
Argentina  
Armenia  
Austria  
Azerbaijan  
Bangladesh  
Belgium  
Bolivia  
Bosnia-Herzegovina  
Botswana  
Brazil  
Bulgaria  
Cambodia  
Canada  
Chile  
Colombia  
Costa Rica  
Croatia  
Cyprus  
Czech Republic  
Denmark  
Egypt  
Estonia  
Fiji  
Finland  
Georgia  
Greece  
Guatemala  
Honduras  
Iceland  
Indonesia  
Iran  
Ireland  
Israel  
Ivory Coast  
Jordan  
Kazakhstan  
Kenya  
Kirgizstan  
Laos  
Latvia  
Lebanon  
Lithuania  
Macedonia  
Malawi  
Malaysia  
Mexico  
Moldova  
Morocco  
Myanmar  
New Caledonia  
New Zealand  
Nicaragua  
Pakistan  
Panama  
Papua New Guinea  
Paraguay  
Peru  
Russia  
Saudi Arabia  
Serbia  
Slovak Republic  
Slovenia  
South Korea  
Sri Lanka  
Sweden  
Tajikistan  
Thailand  
Turkey  
Turkmenistan  
Ukraine  
United Arab Emirates  
Uzbekistan  
Vietnam  
Yemen  
Zimbabwe

## HEADQUARTERS AND PRODUCTION PLANTS

### CHIORINO S.p.A.

Via S. Agata, 9  
I-13900 Biella, Italy  
Tel. +39 015 8489 1  
Fax +39 015 849 61 61  
chiorino@chiorino.com  
www.chiorino.com

UNI EN ISO 9001:2015  
UNI EN ISO 14001:2015  
OHSAS 18001:2007  
EMAS



ENGINEERING ADVICE  
ON-SITE INSTALLATION SERVICE  
AFTER SALES SUPPORT

